



## Custom Dust Collection Booths

Fugitive dust, smoke and fumes are removed from the open production area and contained within the booth. The Enviro-Cell eliminates the need for central dust safe working environment. House-keeping is restricted to the interior of the booth. The work area is continuously cleaned by cartridge filters offering filtration capabilities of 99.8% efficiency down to 0.5 microns. Air discharge is recirculated back into the environment. Knocked down Booth Panels are custom designed to meet customer specifications.

### Standard Features

- **All Welded Heavy Sheet Steel**
  - 12 Gauge Steel will stand up to years of daily abuse
- **Filter Racking System**
  - Provides a tight and even seal between the filter and fan assembly
- **Auto Reverse Pulse Filter Cleaning**
  - Compressed air manifold delivers a pulse of air to clean the filters
- **Dust Drawers**
  - Easily remove dust from the bottom of the dust collector located on the booth side.
- **Urethane Mastic External Coating**
  - Durethane DTM by PPG chemically resistant and extremely durable. Provides excellent corrosion resistance with superior color and gloss retention.
- **Custom Booth Sizes**
  - Booths are custom built to the needs of the customer and can be constructed of various materials, sound insulation and crane slots.

### HIGHLIGHTS

#### PULSE FILTER CLEANING

The compressed air manifold for filter blowdown is nested inside the unit for convenient system installation against an existing wall or corner. Pulse Controls are standard, complete with Photohelic Gauge monitoring, and supplied with a timer in a NEMA 12 control box. Motor controls, if supplied, are housed in the same control box for ease of connection. Custom capacities are also available.

#### MAINTENANCE ACCESS

The aluminum louvered front access panels remove easily for access to the filter chamber. Additionally, the dust drawer is accessible under the aluminum panels from the booth side of the dust collector for simple dust removal.

## Popular Options

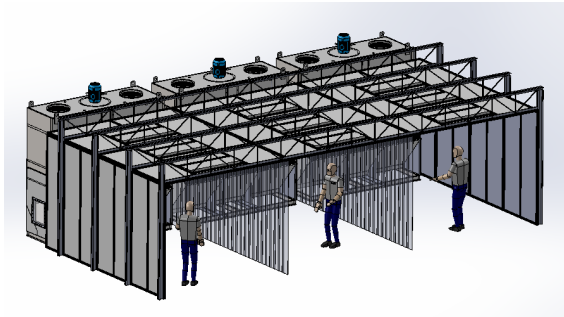

Custom enclosures designed for your specific application / workflow.

Custom flush mounted lighting for a bright and safe work zone.

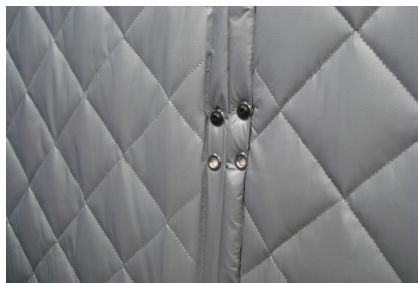

Sound insulated panels

Custom crane slots available to easily transport heavy material into the booth area.



All ProVent equipment is available in painted or unpainted stainless steel. Popular with the food processing industry, stainless steel provides cleanliness and longevity to the equipment.

ProVent Silencers reduce the noise level produced by the exhausted air. ProVent manufactures silencers that are perfectly matched to the collectors they serve.



**Total Air/Energy**  
**SOLUTIONS**  
Technology • Efficiency • Performance



Sales@TotalAirEnergy.com

www.TotalAirEnergy.com

Phone 206.454.7070

Fax 206.892.9644

727 S. Kenyon St., Seattle, WA 98108

## Specifications

| Model                    | EWC-4  | EWC-6                             | EWC-8                             | EWC-10                             | EWC-12                             | EWC-16                             |
|--------------------------|--|-----------------------------------|-----------------------------------|------------------------------------|------------------------------------|------------------------------------|
| Air Flow                 | 4,000  | 6,000                             | 8,000                             | 10,000                             | 12,000                             | 16,000                             |
| Static Pressure (in. Wg) | 3  | 3                                 | 3                                 | 3                                  | 3                                  | 3                                  |
| Dry Weight (lbs)         | 1,800  | 2,800                             | 3,000                             | 3,500                              | 3,800                              | 4,200                              |
| TEFC Motor, HP           | 3  | 5                                 | 10                                | 15                                 | 15                                 | 20                                 |
| Motor Full Load Amps     | 4.8  | 7.6                               | 14                                | 21                                 | 21                                 | 27                                 |
| Motor / Fan RPM          | 1750   | 1750                              | 1750                              | 1750                               | 1750                               | 1750                               |
| Primary Voltage          | 460 Volt 3 Phase 60 Hertz  |                                   |                                   |                                    |                                    |                                    |
| Fan Size                 | 182 BC, 100%   | 200 BC 100%                       | 245 BC, 63%                       | 270 BC, 56%                        | 270 BC, 56%                        | 270 BC, 89%                        |
| Fan Type                 | AMCA Rated, Backward Curved, Single Width, Mild Steel  |                                   |                                   |                                    |                                    |                                    |
| Housing Construction     | 12,10 Gauge and 3/16", Solid Welded  |                                   |                                   |                                    |                                    |                                    |
| Motor Controls           | NEMA 12 Start / Stop with Overload Protection  |                                   |                                   |                                    |                                    |                                    |
| Filter Media Square Foot | 1356   | 2260                              | 3390                              | 4520                               | 4520                               | 6780                               |
| Filter Media / Cartridge | 80 / 20 Cellulose / Polyester Blend  |                                   |                                   |                                    |                                    |                                    |
| Filter Cartridge         | (6x) 26" L W/ 14 x 16" Top Flange  | (5x) 52" L W/ 14 x 16" Top Flange | (5x) 52" L W/ 14 x 16" Top Flange | (10x) 52" L W/ 14 x 16" Top Flange | (10x) 52" L W/ 14 x 16" Top Flange | (10x) 52" L W/ 14 x 16" Top Flange |
| Filter Cleaning          | (1) Digital Sequencer / Timer with Internal DP Switch for On-Demand and Off-Line Pulse Cleaning. Includes Digital DP gauge; (2x) 1" Diaphragm Valves.  |                                   |                                   |                                    |                                    |                                    |
| Compressed Air           | 80-90 PSI Required Hook-Up; 1/2" NPT Coupling  |                                   |                                   |                                    |                                    |                                    |
| Clean-Out Drawer Dim.    | (2x) 23" W x 30" D x 6" T  | (4x) 18" W x 30" D x 6" T         | (4x) 22" W x 39" D x 6" T         | (4x) 22" W x 39" D x 6" T          | (4x) 22" W x 39" D x 6" T          | (4x) 2" W x 55" D x 6" T           |
| External Coating         | Durethane DTM by PPG is a Direct-To-Metal Urethane Mastic Coating that is Chemically Resistant and Extremely Durable. It Provides Excellent Corrosion Resistance and has Superior Color and Gloss Retention, Excellent Adhesion, UV Protection, and is Abrasion Resistant. |                                   |                                   |                                    |                                    |                                    |